

D-7 Series — Durant®



Cat. No. 5-D-7-1-L-CL

Product Selection

Table 54-14. Product Selection — D-7 Series Revolution Counters

No. of Figures	Drive	Rotation	Reset	Mounting	Catalog Number	Order Number	Price U.S. \$
5	L.H.	Clockwise ③	Wing Nut	Base	5-D-7-1-L-CL	31127408	
5	L.H.	Anti-Clockwise ④	Wing Nut	Base	5-D-7-1-L-AC	31127405	
5	R.H.	Clockwise ①	Wing Nut	Base	5-D-7-1-R-CL	31127431	
5	R.H.	Anti-Clockwise ②	Wing Nut	Base	5-D-7-1-R-AC	31127400	
5	L.H.	Clockwise ③	None	Base	5-D-7-3-L-CL	31127416	
5	L.H.	Anti-Clockwise ④	None	Base	5-D-7-3-L-AC	31127412	
5	R.H.	Clockwise ①	None	Base	5-D-7-3-R-CL	31127438	
5	R.H.	Anti-Clockwise ②	None	Base	5-D-7-3-R-AC	31127442	

Product Description

Model D-7 Series spur gear end drive units are compact counters that meet a variety of needs. Accurate, dependable and moderately priced, they are especially recommended for braiding machines, low-speed coil winders, wire measuring equipment and all medium-duty revolution applications.

Technical Data and Specifications

- Figures: 5 standard
- Speed: Up to 800 cpm in 1:1 ratio
- Rotation Direction: Clockwise or anti-clockwise when viewed from right-hand end of counter
- Ratio: 1:1 standard
- Shaft: 0.31" (7.9 mm) diameter stainless steel; 0.66" (16.7 mm) right-hand drive, 0.63" (15.9 mm) left-hand drive
- Drive: Right- or left-hand spur gear drive
- Bearings: Oil-less, maintenance free
- Figure Size: 1/4 inch (6.4 mm) high, black-on-white background
- Finish: Black frame and cover
- Reset: Wing nut or non-reset

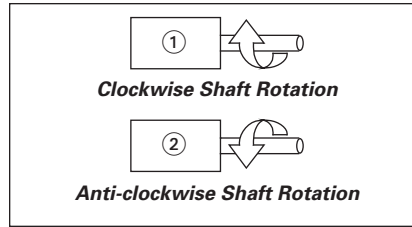

Figure 54-14. Top View — Right-Hand Drive

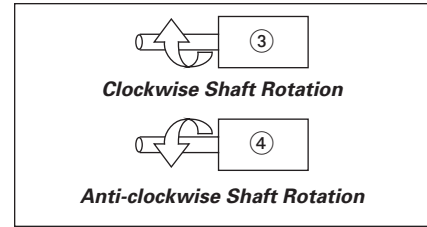

Figure 54-15. Top View — Left-Hand Drive

Note: When shaft is turned in the reverse direction of rotation, the counter will subtract.

When Ordering Specify

To determine a model number from the Product Selection table for Model D-7 Series Revolution Counters, consider:

- Number of figures
- Shaft rotation direction
- Shaft drive
- Reset or Non-reset

Dimensions

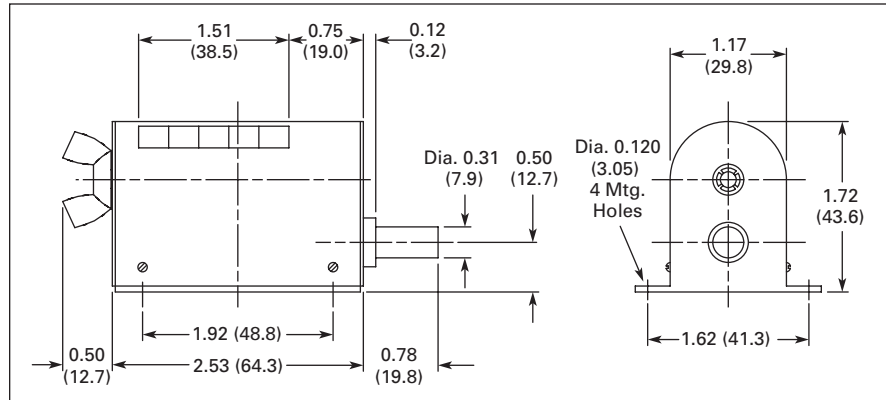

Figure 54-16. D-7 Series — Approximate Dimensions in Inches (mm)